



## Cranbourne Drive

Harpenden, AL5 1RJ

A super four bedroom family home - extended and refurbished by our clients - in a peaceful cul de sac, in the popular Cross Farm area. Close to the amenities of Southdown and beautiful open countryside.

**Guide price £725,000**

# Cranbourne Drive

Harpenden, AL5 1RJ



- Semi-detached family home
- Four Bedrooms
- Peaceful cul de sac
- Well presented throughout
- Private Garden
- Popular Cross Farm location
- Two Reception Rooms
- Garage & Driveway
- Close to amenities of Southdown

## Entrance Hall

## Living Room

12'6" x 10'4" (3.83 x 3.16)

## Kitchen / Breakfast Room

12'4" x 16'8" (3.78 x 5.10)

## Family / Dining Room

13'0" x 9'4" (3.97 x 2.85)

## Cloakroom

## Bedroom One

12'11" x 9'4" (3.95 x 2.85)

## Bedroom Two

12'5" x 8'10" (3.81 x 2.70)

## Bedroom Three

11'4" x 9'6" (3.47 x 2.91)

## Bedroom Four

8'3" x 7'0" (2.52 x 2.15)

## Family Bathroom

## Garage

14'9" x 7'10" (4.50 x 2.40)

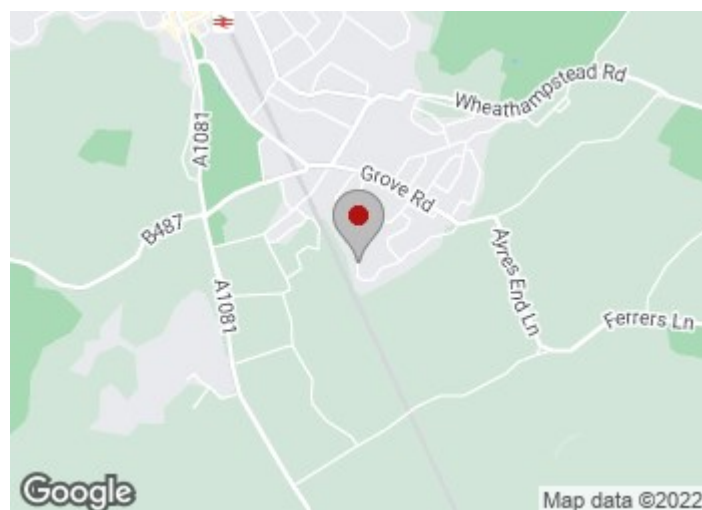



# Floor Plan

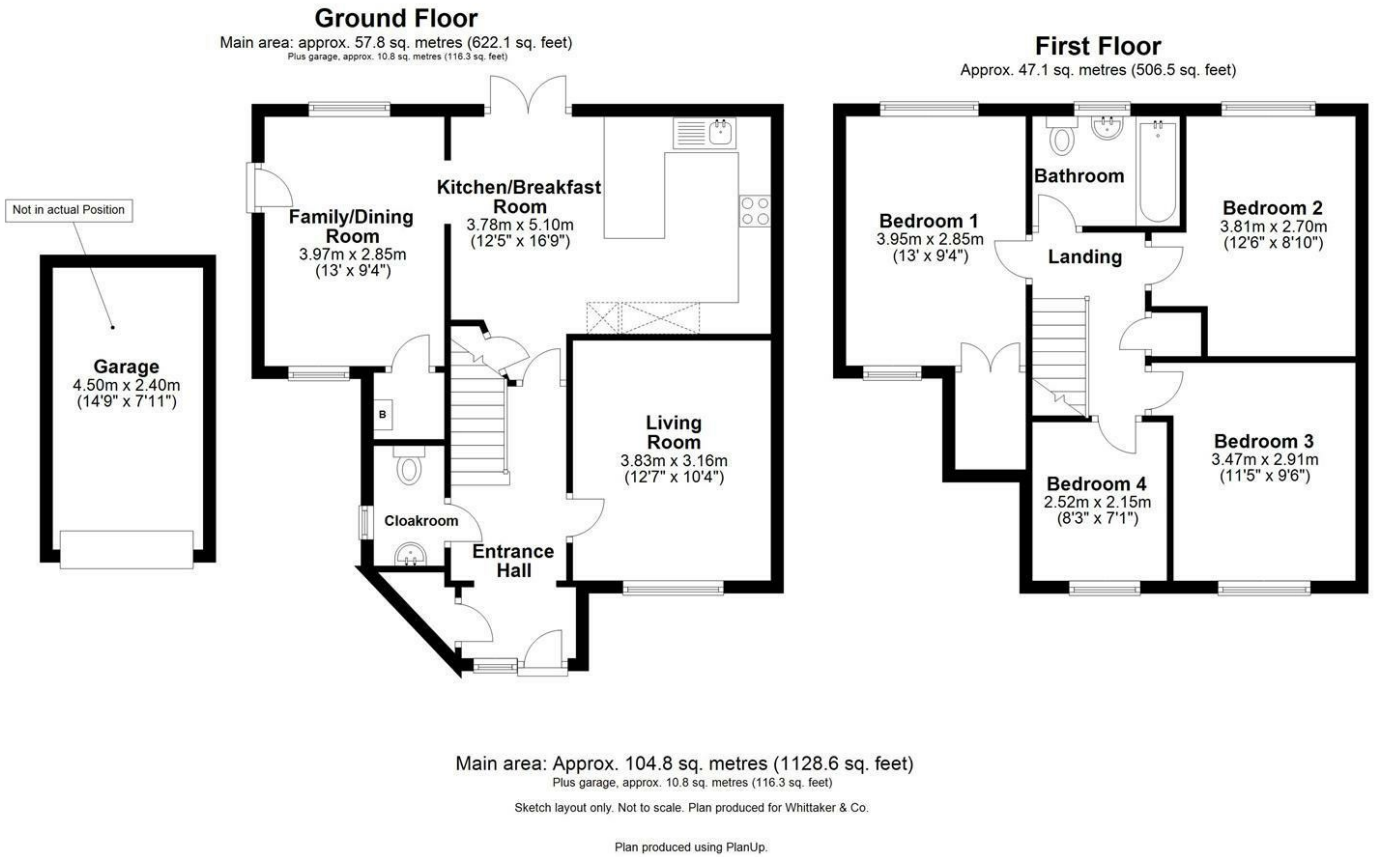

These particulars, whilst believed to be accurate are set out as a general outline only for guidance and do not constitute any part of an offer or contract. Intending purchasers should not rely on them as statements of representation of fact, but must satisfy themselves by inspection or otherwise as to their accuracy. No person in this firm's employment has the authority to make or give any representation or warranty in respect of the property.

